

DESIGN A "RUBE GOLDBERG" MACHINE

A Rube Goldberg machine is something that gets a job done in a very impractical way. Go over the example below, then design your own Rube Goldberg machine on a separate page. Be sure to explain how it works, too!

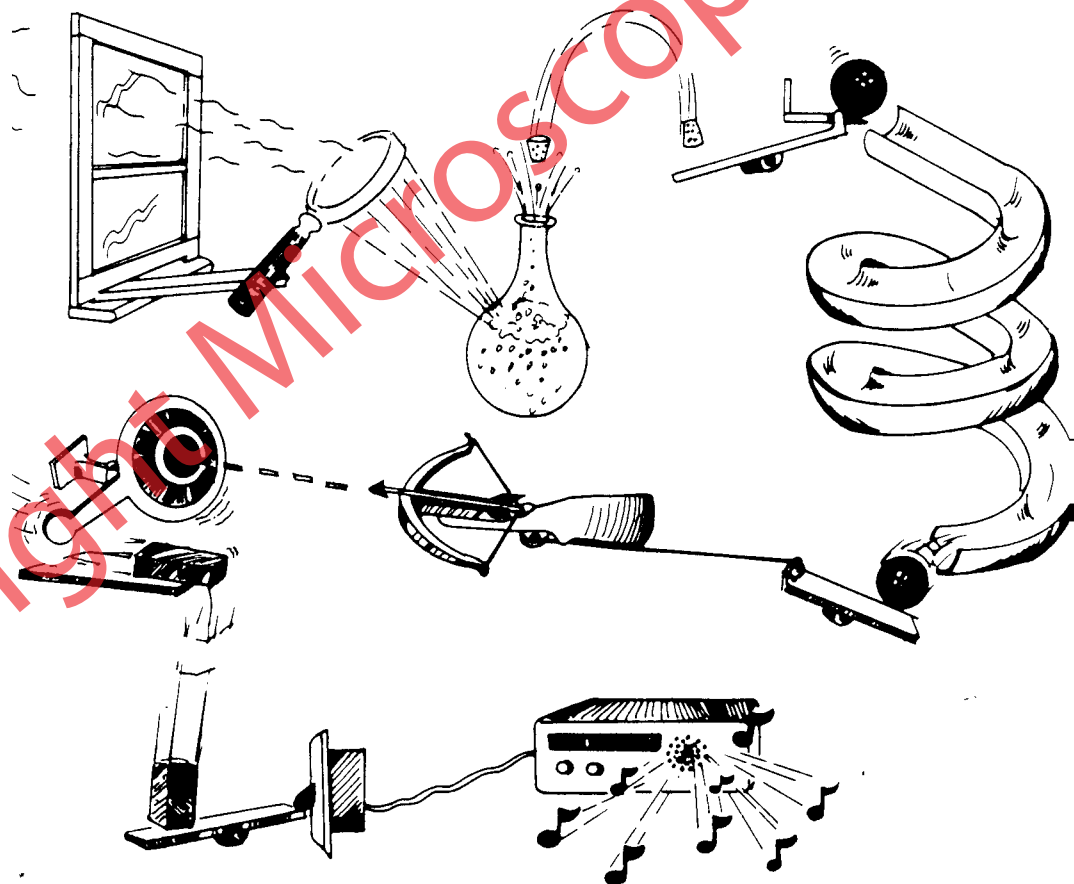

A "Rube Goldberg" Alarm Clock

How it works: Sun shines through the window, through the magnifying glass which boils water in the flask, which pops the stopper off, which lands on the lever. The lever dislodges the ball, the ball goes down the ramp and hits the lever which pulls the string which pulls the trigger of the crossbow. The arrow hits the target causing it to pivot knocking the brick off the ledge onto the lever, which turns on the power switch, which turns on the radio and wakes us up!