

[www.MicroscopeWorld.com](http://www.MicroscopeWorld.com)

6122 Innovation Way

Carlsbad, CA 92009

800-942-0528

760-438-0553 Fax

760-438-0528 International

[info@microscopeworld.com](mailto:info@microscopeworld.com)



MicroscopeWorld

## STEP BY STEP DIRECTIONS FOR SETTING UP YOUR S6-HD MICROSCOPE:



1. Loosen the silver set screw on the focusing holder stand.



2. There are 4 dust caps that need to be removed from the body of your microscope:

- I. Remove the 2 dust caps from each of your eyetubes by pulling the dust cap off.



- II. Pull the dust cap off that is covering your trinocular port.

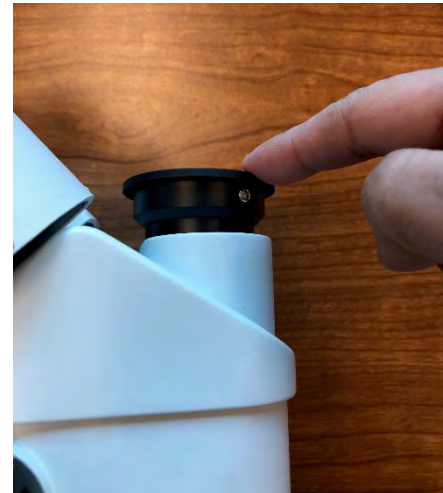

- III. Lastly, unscrew the dust cap covering the nose of the microscope.



3. Next, insert the body of the microscope into the focusing holder of the stand. Once resting in the focusing holder, you can re-tighten the silver set screw on the focusing holder.





4. You'll then insert each eyepiece into each of the eyetubes.

*\*\*\*The rubber eyeshields are folded down during transit, you can flip them up so they're fully extended for better viewing comfort if you prefer.*



5. Next, using a 3mm size allen wrench, loosen the two silver screws on either side of the top of the trinocular port of the microscope.



6. Next, insert the C-Mount adapter into the trinocular port so that it is resting level.



7. Once resting, re-tighten both silver set screws on the trinocular port so that the adapter is secured tightly in place.



8. There is a dust cap on the C-Mount adapter that you'll want to remove by unscrewing it.

*\*\*\*It is not necessary to save the dust caps, but if the microscope will be transported, they can help keep optics cleaner.*





9. Next, pull the dust cap off the bottom of your camera.



10. You'll then screw the camera onto the threads of the C-Mount adapter until the camera is stable (be careful not to overtighten the camera).





11. Next, note that there is a silver screw on the back of the monitor.

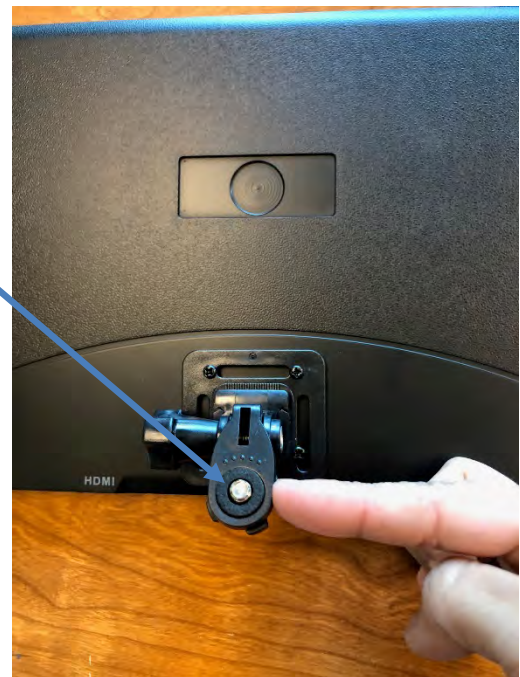



That silver set screw, will insert into the center mounting hole at the bottom of your camera.



12. With that in mind, insert the silver set screw of your monitor into the center mounting hole of the camera and tighten until the monitor is fully secured into the mounting hole.

*\*\*At first glance, the screw seems too shallow to fit, but it will and the monitor will sit securely mounted to the camera.*





13. There is another screw on the monitor that can be loosened and tightened in order to adjust the angle you would like the monitor to sit at.





14. Next, remove the dust caps from your HDMI cable





15. Insert the straight end of the HDMI cable into the HDMI port on the camera.



16. You'll the insert the other end into HDMI port on the monitor.

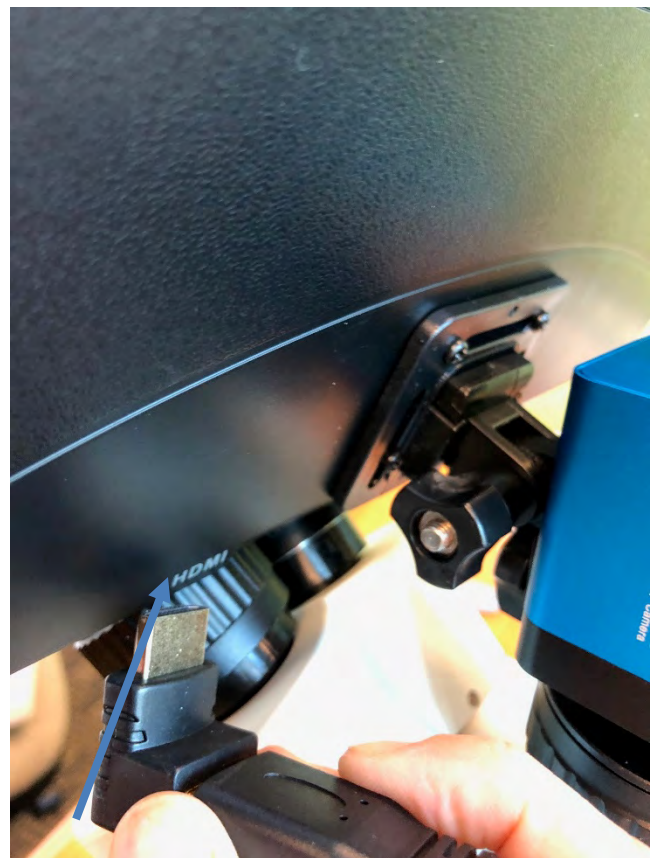



17. Next, take the end of your camera power supply and insert it into the single end of the splitting adapter.

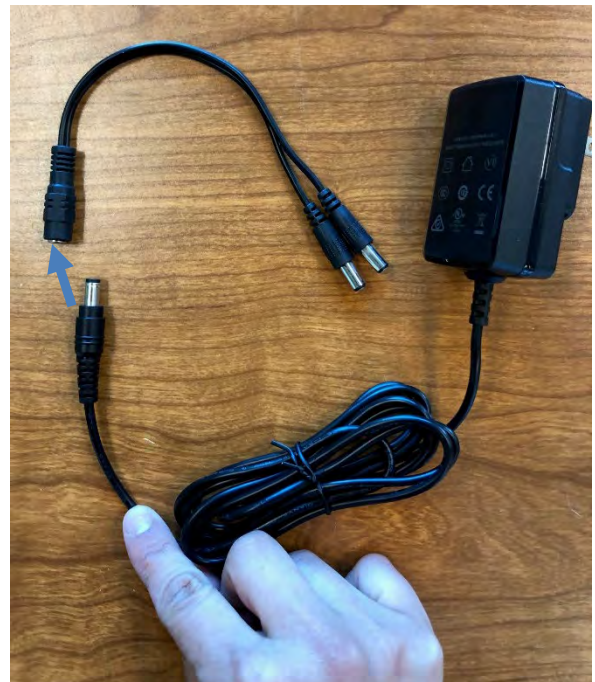

18. Take one end of the splitter and insert it into the “DC12V” port on the camera.

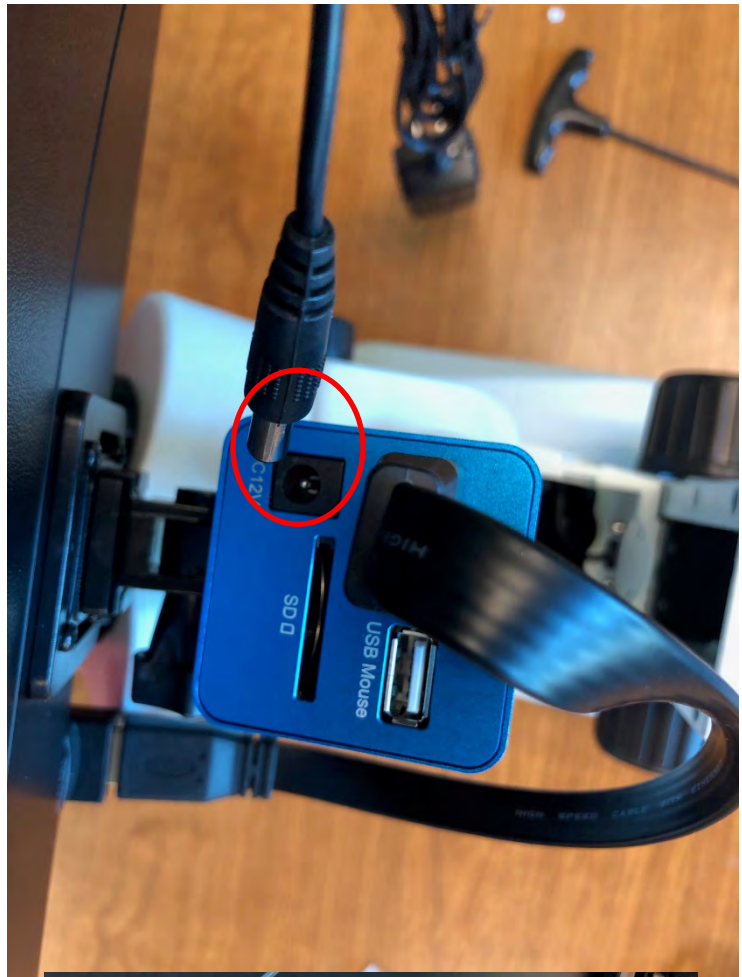

Take the other end and insert it into the “DC-12V” port on the monitor

Plug the other end of the power supply into a wall outlet.





19. Next insert the USB end of the Mouse into the “USB Mouse” port of the camera.



20. Lastly, you'll want to insert the power cable into the base of the stand and the other end into a wall outlet.



21. The on/off button to operate the camera is on the right hand side of the monitor.



22. The on/off button for the illuminators of the stand is on the right hand side of the base of the stand.

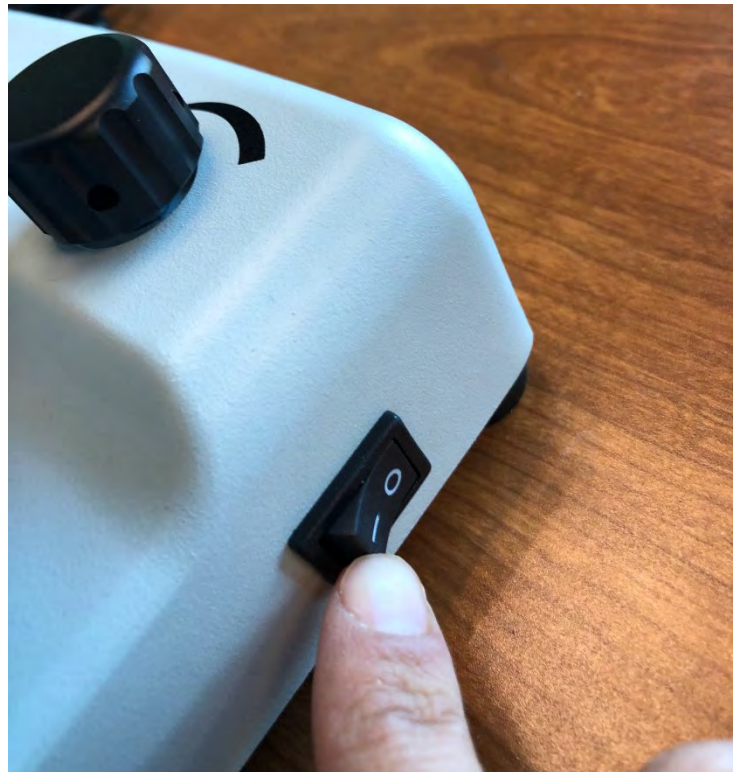



23. Once you turn the power switch to the “On” position, the top and bottom rheostats will need to be adjusted to increase the intensity of the illuminators since they can be turned off and on apart from each other.

