

# EasyLED Spot Lights

for stereo microscopy

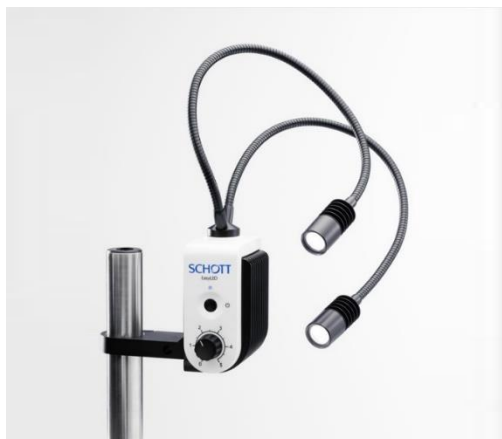

EasyLED Spot Lights are available in two different versions: an individual spot light with a single light head (Spot Light Plus Single), and a double spot light with two light heads (Spot Light Plus Double). In addition, the two light heads of the Spot Light Plus Double can be controlled individually.

### Features:

- Powerful light flux of 130 lm for each spot.
- Robust metal light head equipped with special cooling lamellae.
- Integrated controller.
- Mountable direct to the stand. Mounting brackets for all stands plus a standalone version are all available.

### Advantages:

- Ergonomic design – the dimming control is ergonomically placed near the focus control of the microscope.
- Robust design for operation in demanding environments.
- For the Spot Light Plus Double, both spots can be switched individually.

## Types and compatibility

General		Spot Light Plus Single	Spot Light Plus Double
Part No.		600.101	600.121
Dimensions – control unit (W x D x H)	(mm / inch)	Approx. 61 x 114 x 107 / 2.40" x 4.49" x 4.21	
Dimensions – Length Spot incl. Light Head	(mm / inch)	500 / 19.69	
Weight	(kg)	Approx. 0.5	Approx. 0.7
Cooling		Convection	
<b>Electrical</b>			
<b>- Power supply unit -</b>			
Operating voltage, frequency		100 – 240 V ~, 50 – 60 Hz	
Power consumption	(VA)	max. 6	
Protection class power supply		II	
Protection class light source		III	
Overvoltage category		II	
<b>- Controller -</b>			
Supply Voltage	(V)	5 DC	
Lamp type		High Power LED	
Lamp lifetime	(h)	50.000 <sup>1</sup>	
<b>Lighting information</b>			
Luminous flux	(lm)	130	
Color temperature	(K)	Appr. 5.600	
Light exit angle	(2α <sub>eff</sub> )	Approx. 53°	
<b>Certificates</b>			
Conformity		CE, UKCA (power supply unit CE, UL, PSE)	
EMC-class		B	

<sup>1</sup> max. decline of light output to 70% of origin level

We provide a variety of accessories for our EasyLED Series. For details please refer to our system diagrams or according datasheets.



## Dimensions

### Spotlight Plus Single



P/N: 600.101

### Spotlight Plus Double



P/N: 600.121

### Dimensions light head

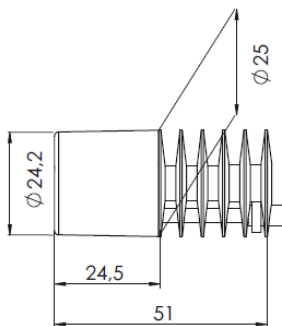

Pictures are provided for illustration purposes only, and may not provide an accurate reflection of the actual product.



MicroscopeWorld

info@microscopeworld.com | 800-942-0528

All specifications are subject to change without prior notice. This datasheet or any extracts thereof may only be used in other publications with express permission of SCHOTT. © SCHOTT AG

Lighting and Imaging  
**SCHOTT AG**  
Hattenbergstrasse 10  
55122 Mainz  
Germany

Phone: +49 (0) 6131/66-7796  
Fax: +49 (0) 6131/66-7850  
info.microscopy@schott.com  
www.schott.com/microscopy

**SCHOTT**  
glass made of ideas