

# Moticam ProS7 MONO

## Features & Application

The camera adopts Sony Pregius technology back-illuminated CMOS sensor, featuring extremely high sensitivity and ultra-low noise, fast imaging speed and distortion-free images.

It uses USB 3.1 data transmission technology to achieve fast and stable data and image transmission.

With an aluminum alloy appearance, it is sturdy and durable.

Advanced and professional video and image processing software is provided, meeting the needs of various application scenarios.

Windows, Linux and MacOS SDKs are also provided.

The camera supports trigger mode and ROI mode, suitable for various microscopic image scenarios such as bright field, low light, polarized light and fluorescence, and can also be applied to various machine vision scenarios.



## Product Specification

SAP Code	1100600101701
Resolution	3200x2200@46fps(1600x1100 @120fps)
Pixel Size	4.5μm x 4.5μm
Sensor Size	14.4x9.9 (1.1" )
Data Interface	USB3.1
Camera Interface	Type C
Color/Black and White	Black and White
Shutter Type	Global Shutter
Cooling Method	Refrigerated Camera

## Dimensions

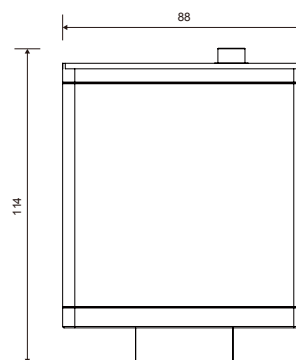
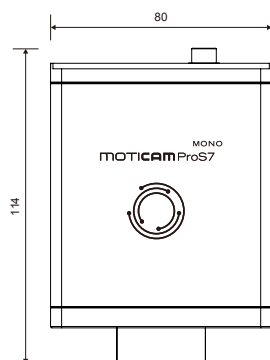

\* Certification: CE、FCC