

# Swift SM100 Series Stereo Microscope Use and Care Manual

SWIFT OPTICAL *Enduring Quality and Technical Excellence*



## SWIFT SM100 SERIES STEREO MICROSCOPE

The Swift SM100 Series stereo microscope is a full size, well-balanced, stereoscopic instrument producing an erect, three-dimensional image with a large, comfortable field of view.



**To Order Parts:**  
**www.Swift-MicroscopeWorld.com**  
**800-942-0528 Toll Free**  
**760-438-0528 International**  
**info@swift-microscopeworld.com**

## SWIFT OPTICAL INSTRUMENTS, INC. LIMITED LIFETIME WARRANTY

The Swift Optical Instruments, Inc. Limited Lifetime Warranty assures that the microscope is guaranteed against defects in material and workmanship for the life of the product. Electrical components are covered for three years; video components are covered for one year after purchase. Normal wear, routine maintenance, light bulbs, power supplies, rechargers, batteries, fuses, cords, add-on accessories, damage resulting from repair by unauthorized parties, accident, alteration, shipping, misuse or abuse is not covered. Warranty service is provided by Swift Optical Instruments, Inc.'s authorized technicians. Determination of warranty is at the technician's discretion.

Other than set forth above, Swift hereby disclaims all warranties, expressed or implied, of fitness for a particular purpose.

Defective products covered by the warranty will be repaired free of charge when they are returned, postpaid, to:

Swift Optical Instruments, Inc.  
Attn: Warranty Repair  
11113 Landmark 35 Drive  
San Antonio, TX 78233

For all warranty repairs or service requests, please call the Swift repair department at (877) 967-9438 before anything is shipped. This warranty gives you specific legal rights, and you may also have other rights which vary from state to state.

\*For customers living outside the United States, Swift Optical Instruments, Inc. will provide standard warranty service. However, inbound & outbound shipping cost is the responsibility of the consumer.

**Swift Optical Instruments, Inc. • (877) 967-9438 •**  
**www.swiftoptical.com**



**B. PROBLEM** - Unable to bring specimen into focus.

**CORRECTION** -

1. Eye lens of the eyepiece is partially unscrewed. Remove the eyepiece and screw the two sections together.
2. The black turret knob may need to be fully rotated to align the objective lenses into the correct position.
3. The specimen may not be centered properly on the stage and needs to be re-positioned to be in the optical path.

**C. PROBLEM** - Image of the specimen goes out of the focus all by itself.

**CORRECTION** - Use the tension control collar to tighten the focusing mechanism found on the focusing spindle.

**D. PROBLEM** - Focusing knobs turn with difficulty even with tension-collar loosened.

**CORRECTION** - Microscope should be disassembled, cleaned and re-lubricated by a qualified, authorized technician.

**PARTS and ACCESSORIES**

- MA10589 N-WF10X/20 (single)
- MA10590 N-WF10X/20 adjustable Diopter (single)
- MA14780 3.5V 150mA LED Bulb (Top illuminator)
- MA14781 3.5V 150mA LED Bulb (Arm illuminator)
- MA14782 3.5V 150mA LED Bulb (Bottom illuminator)
- MA14281 Power supply converter (100-240VAC in, 4.5VDC 1a out)
- MA19029 Rubber Eyeshields, pair
- MA2620B Black Stage Plate
- MA2620W White Stage Plate
- MA2621 Frosted Stage Plate
- MA533 Dustcover

**SM100 CORDED SERIES STEREO MICROSCOPE  
SPECIFICATIONS**

Model Number	SM101	SM102	SM105
Objectives	1X, 3X	2X, 4X	1X - 3X ZOOM
Eyepieces	W10X, FN20	W10X, FN20	W10X, FN20
Total Magnification/ Field of View	10X / 20mm 30X / 6.5mm	10X / 10mm 40X / 5mm	10X / 20mm 20X / 10mm 30X / 6.5mm
Working Distance	77mm	77mm	77mm
SM100 Illuminator (incident & transbase)	Turret variable 6 x .06W LED, Top variable .5W, Bottom .5W LED. Corded Stand	Turret variable 6 x .06W LED, Top variable .5W, Bottom .5W LED. Corded Stand	Turret variable 6 x .06W LED, Top variable .5W, Bottom .5W LED. Corded Stand

**SM100 CORDLESS SERIES STEREO MICROSCOPE  
SPECIFICATIONS**

Model Number	SM101-C	SM102-C	SM105-C
Objectives	1X, 3X	2X, 4X	1X - 3X ZOOM
Eyepieces	W10X, FN20	W10X, FN20	W10X, FN20
Total Magnification/ Field of View	10X / 20mm 30X / 6.5mm	10X / 10mm 40X / 5mm	10X / 20mm 20X / 10mm 30X / 6.5mm
Working Distance	77mm	77mm	77mm
SM100 Illuminator (incident & transbase)	Turret variable 6 x .06W LED, Top variable .5W, Bottom .5W LED. Corded Stand	Turret variable 6 x .06W LED, Top variable .5W, Bottom .5W LED. Corded Stand	Turret variable 6 x .06W LED, Top variable .5W, Bottom .5W LED. Corded Stand

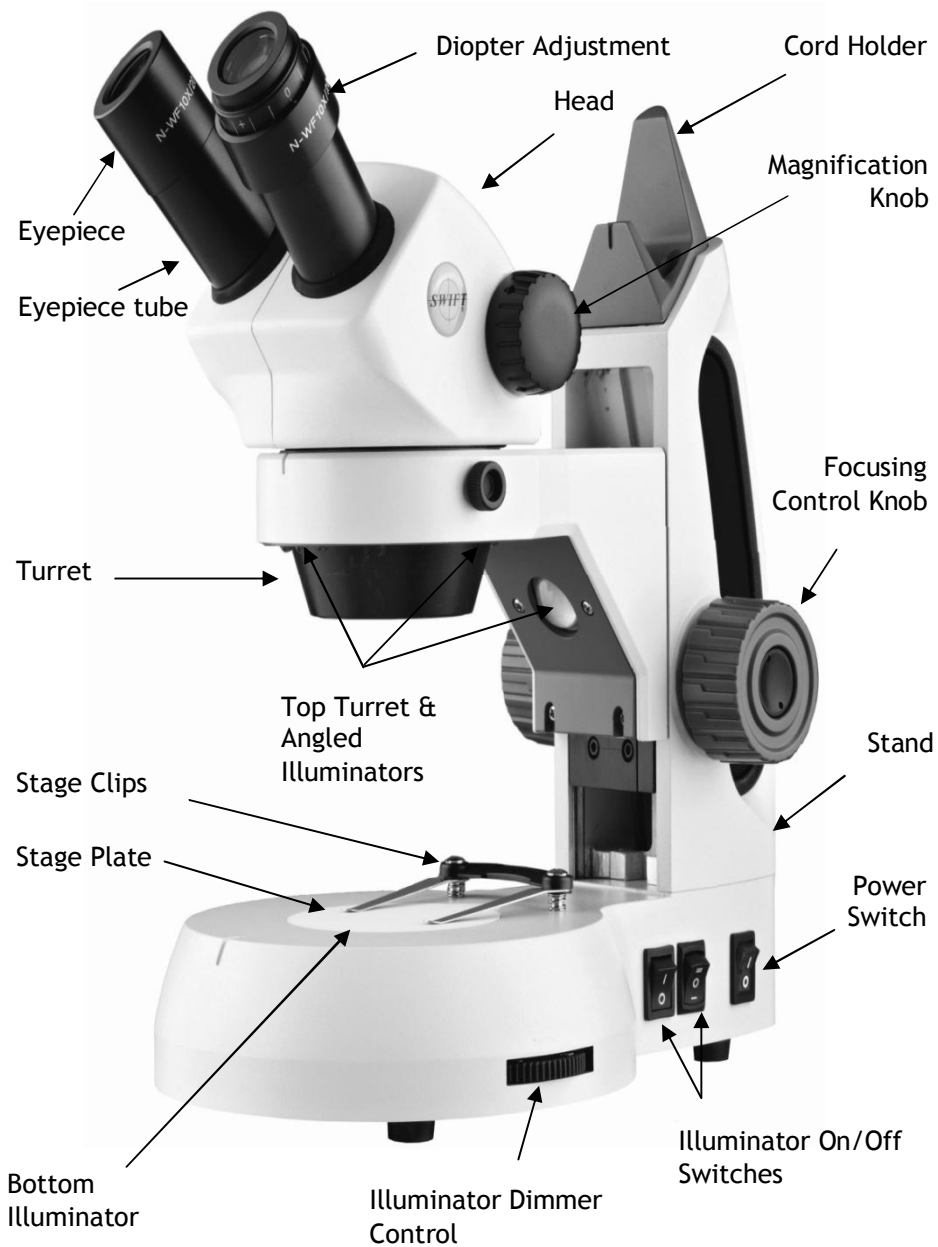

(SM105-C Pictured)

## TENSION CONTROL OF FOCUSING MOVEMENT

The focus tension is easily adjusted by using the Swift adjustment wrench. This wrench fits the tension collar found on the focusing controls, between the knob and upright support. A clockwise turn of this collar moves it toward the upright support and increases tension, while a counter clockwise turn moves the collar toward the knob and decreases tension (see illustration).

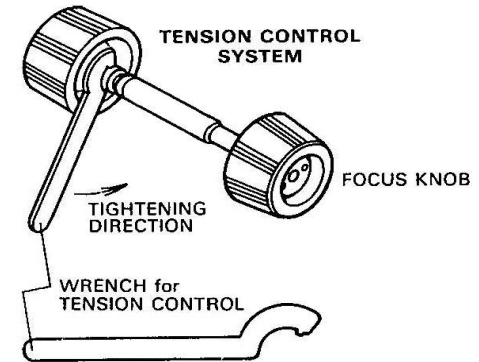

**COMMON PROBLEMS IN MICROSCOPY**  
 Top (incident) Illuminator a problem, you may be able to correct it yourself. Here are a few common problems and easy solutions you may want to try before calling for service.

**CAUTION** - Never disassemble mechanical or optical components. This servicing should only be done by an authorized Swift technician. The Limited Lifetime Warranty will be null and void if the mechanical or optical components are disassembled by a non-Swift dealer.

- A. PROBLEM** - The illuminator light does not come on  
**CORRECTION** -
1. Make sure the microscope is plugged into a functional electrical socket.
  2. Make sure the bottom illuminator dimmer control is set above "0"
  3. The bulb may need to be replaced. See "Bulb replacement" on page 8.

## BULB REPLACEMENT

Unplug the stereo microscope from the electrical outlet and remove specimens from the stage before you attempt to replace an LED.

To prolong the life of the LED, you should always turn off the unit when not in use.

The extra long life LED incidental (top) illuminator bulbs (Swift MA14780 & MA14781) can be replaced by removing the five retaining screws holding on the Illumination plate (See Fig 1.). This will require the use of a short handle screw driver. They can then be unclipped and replaced (See Fig 2.).

The transmitted (bottom) illumination bulb is Swift MA14782 3.5V 150mA LED Bulb. The bottom bulb may be replaced by carefully laying your stereoscope on its side and using a Phillips screw driver remove the four screws securing the rubber feet and base plate to illuminator base. Remove four 3mm Phillips head screws securing lamp housing to lamp bracket; then remove lamp housing. Carefully unplug LED lamp connector. Replace LED lamp assembly and then, reverse the above process.

Fig 1.



Fig 2.

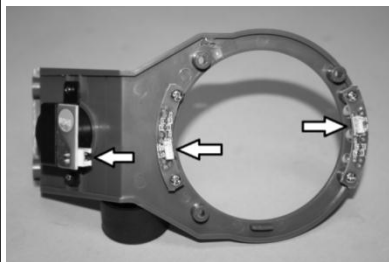

## COMPONENTS OF THE STEREO MICROSCOPE

**BOTTOM ILLUMINATOR** - This is the light source mounted in the base to provide trans-illumination.

**DIOPTRIC ADJUSTMENT** - Located on the left eyepiece tube of the SM100 Series. This adjustment is used to fine focus the optics to compensate for visual differences between the user's eyes.

**EYEPIECE** - The upper optical element that further magnifies the primary image of the specimen and brings the light rays in focus at the eyepoint.

**EYEPIECE TUBE** - This is the part of the head that holds the eyepieces in place. Set screws in the eyepiece tubes can be used to lock the eyepieces in place.

**STAGE CLIP** - Used to hold specimen in place.

**FOCUSING CONTROL KNOB** - The focusing control knobs located on either side of the stand are used to raise or lower the head to bring the specimen into focus. The control knobs incorporate a slip clutch system which prevents the head from traveling past both ends of the focusing range. When the focusing limit is reached, the clutch system begins to slip to prevent gear damage.

**HEAD** - The 360° rotatable component that contains all of the optical elements of the stereo microscope including the eyepieces, refracting mirrors and objective lenses. The head of the SM100 series is designed to allow users to adjust the interpupillary distance of the eyepieces for proper viewing.

**ILLUMINATOR DIMMER CONTROL** - The intensity of the top (incident light) LEDs or bottom (trans-illumination) LED can be adjusted to the preferred brightness (0 through 10) by using the dimmer control located on the side of the base.

**ILLUMINATOR ON/OFF SWITCHES** - A tri-illumination system is incorporated into the stand. The illumination system is controlled by top (incident light) and bottom (trans-illumination) on/off switches located at the base of the stand. The incident illuminator is used for opaque specimens, while the trans-illuminator effectively illuminates the internal structure of transparent

specimens. Translucent specimens may be seen in greater detail if both illuminators are used simultaneously.

**MAGNIFICATION KNOB** - Used to change the SM100 series magnification settings.

**STAGE PLATE** - Opaque and black and white stage plates are provided with the microscope stand. The opaque stage plate allows light from the bottom illuminator to pass through. The black and white stage plates can be used for additional contrast to the specimen that is being viewed.

**STAND** - Used to support the stereo microscope head. The height is adjustable which allows the head to change its focusing range. The stand also contains the top and bottom illuminators.

**TOP ANGLED ILLUMINATOR** - The top .5W LED light source is fixed at a 45° angle.

**TOP TURRET ILLUMINATOR** - The top 6 x .06W LED light source is fixed in a downward in a vertical position to provide maximum illumination of the specimen.

**TURRET** - The round barrel that houses the objective lenses. The SM100 Series has magnifications that can be changed by rotating the black turret magnification knob to a different set of objective lenses.

## OPERATING YOUR SM100 SERIES STEREO MICROSCOPE

1. Place the specimen onto the stage plate and select the type of illumination. If the specimen is transparent, turn on the bottom illumination. If the specimen is opaque, turn on the top illuminator.
2. The SM100 series is equipped with built-in magnifications. The knob is clearly marked with the optical magnification setting. To change magnifications, rotate the black turret knob in one direction or in the opposite, as far as it will turn. This will place one pair of objectives in alignment for viewing. The power that is in use is marked on the black turret knob. Please start with the highest objective setting.
3. Look through the eyepieces and rotate the focus control knob to focus the specimen in the field of view.

4. Grasp the eyepiece tubes and move them either closer together or farther apart, to change the interpupillary distance to obtain a clear image. Note, if two separate images are observed, the eyepiece tubes are too far apart and should be moved together. If two overlapping images are seen, the eyepiece tubes are too close together and should be moved apart.
5. Close your left eye and adjust the focus controls so the image is in sharp focus, while viewing with the right eye only.
6. Close your right eye and while viewing with the left eye only, adjust the diopter ring on the left eyetube to bring the image of the specimen into sharp focus. The optical system is now adjusted to your particular vision.
7. Rotate the black turret knob to switch to lowest magnification. Only minor refocusing using the focusing control knob should be required. Your microscope is now parfocused.

## SERVICE AND CLEANING

Use and store your instrument in a dry environment. When not being used, microscopes should be stored with dust covers in place and illuminators turned off. Avoid direct sunlight, high temperatures, moisture, smoke, and fungus. Your Swift stereo microscope is designed to function satisfactorily with only ordinary maintenance. The instrument should be periodically serviced by a qualified, authorized service technician, who will clean, re-lubricate and perform routine adjustments. Eyepieces should be cleaned as often as necessary to allow unobstructed viewing. Clean the eyepieces by brushing away dust particles using a soft camel hair brush or with air pressure, then moistening the lens by breathing onto it. Wipe the lens carefully with quality lens tissue. If dirt or other foreign matter still remains, it may be necessary to use water or optical cleaner (eyeglass or camera lens). Note: the lens tissue should be moistened, not saturated, for cleaning, after which the lens should be dried using a quality lens tissue. Painted surfaces should be cleaned with soapy water or mild non-abrasive cleaners and a soft cloth. Do not use solvents on painted surfaces. Unauthorized personnel should never disassemble lens assemblies or other precision components. For information regarding service, contact your local authorized Swift dealer or Swift customer service at (877) 967-9438.