

## INSTRUCTIONS FOR ASSEMBLY OF UNIVERSAL BOOM STAND

If you purchased this universal boom stand for use with another microscope, please refer to these instructions for stand assembly only.

If you purchased a microscope which was supplied with this stand, the microscope instruction brochure may refer to another type of stand. Refer to that brochure for operational instructions for the microscope only. This pamphlet will assist you in assembly of the universal boom stand, and how to mount your microscope to it.

The complete list and diagram of all parts for the boom stand are on page 4. Make certain you check all parts carefully before discarding any packing material.

The assembly diagram on page 2 does explain how to mount a focusing block (holder for microscope head) on this stand, but the focusing block is a component of the microscope ... not a component of this stand assembly. Therefore, the focusing block is not included on the parts list on page 4, but it is indicated in the assembly diagram on page 3, and in the assembly instructions.

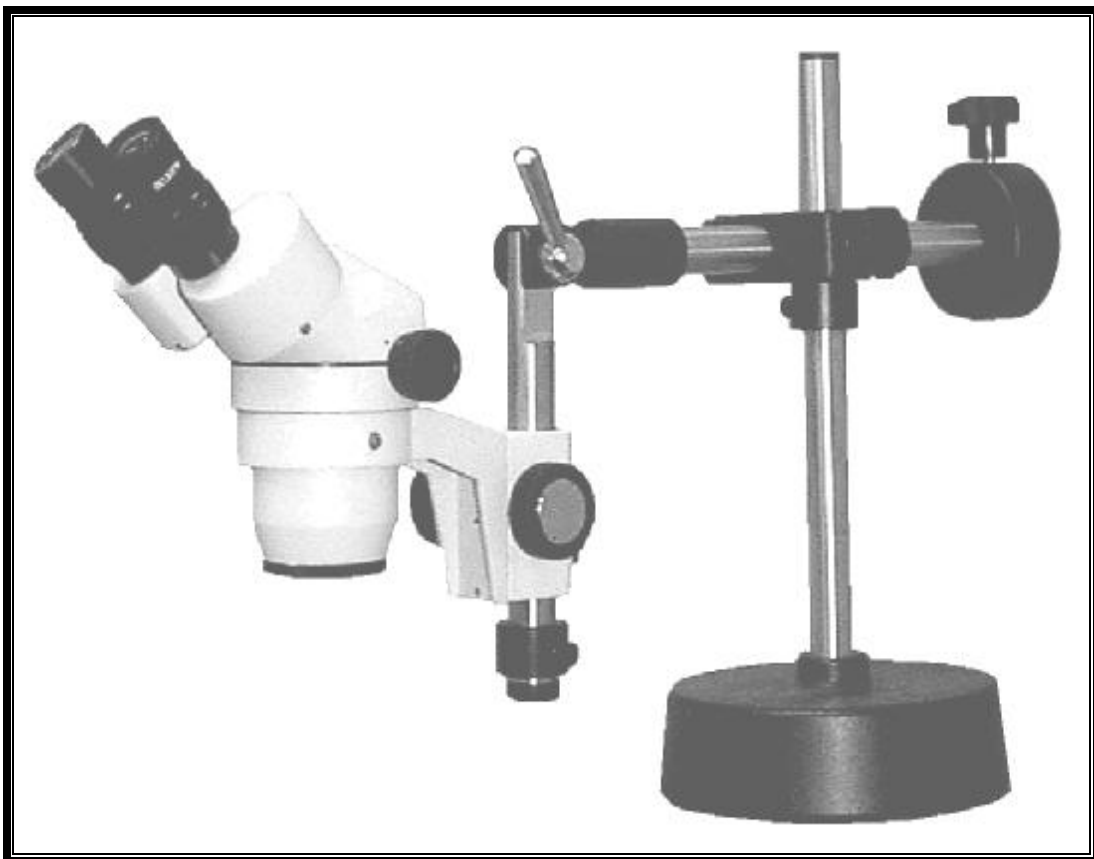

Note: Microscope and focusing block are illustrated for reference purposes only. They are not components of this stand assembly.

ASSEMBLY DIAGRAM

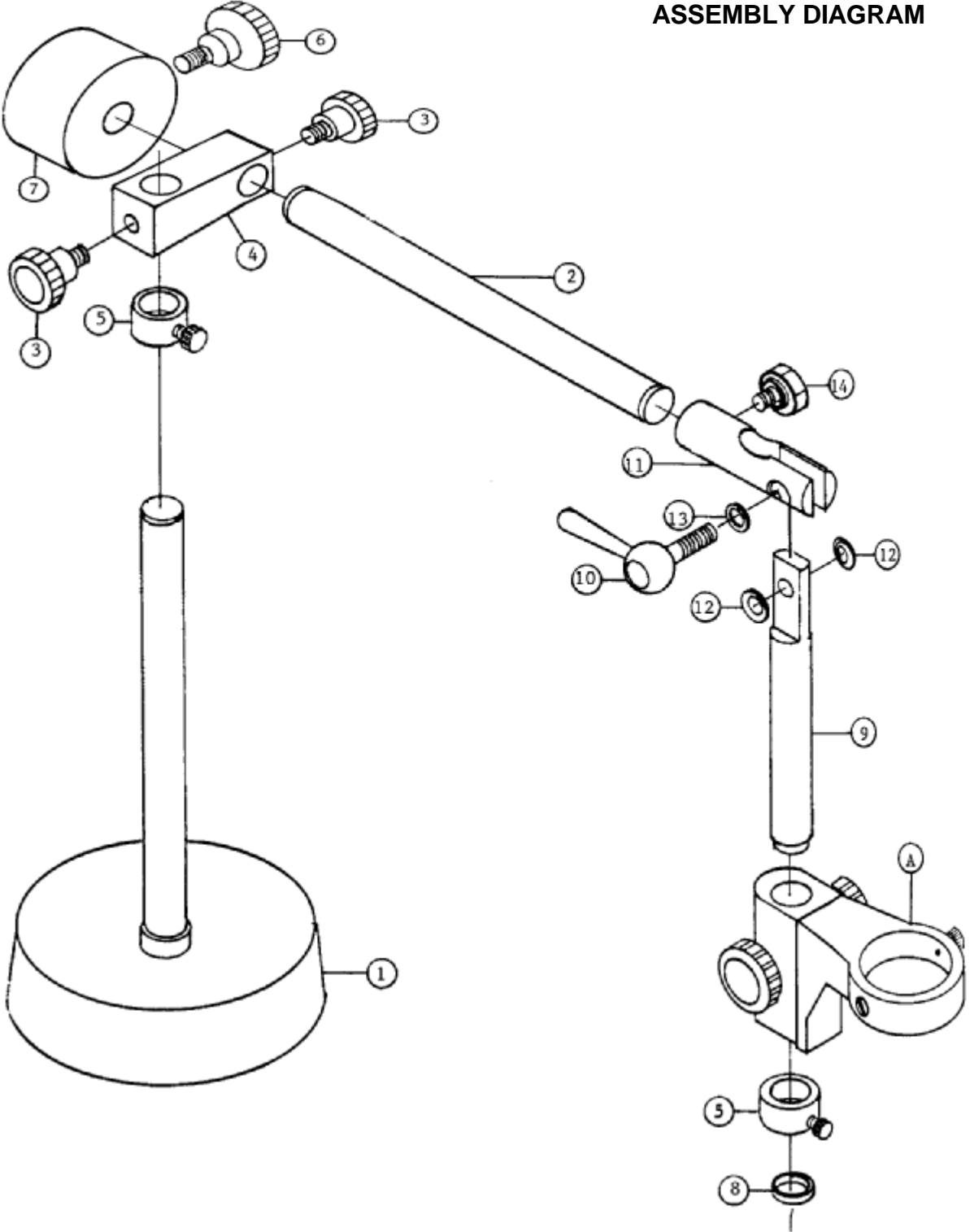

## ASSEMBLY INSTRUCTIONS

- 1) Place base (1) on solid, level surface.
- 2) Slide one support collar (5) on to vertical post of base (1) until it is about 10 inches from top of black portion of base. Tighten locking screw on support collar to secure in place.
- 3) Slide adaptor block (4) onto vertical post of base (1) until it rests on support collar.
- 4) Insert one 38mm knob (3) into threaded hole in each of both ends of adaptor block (4), turning knobs clockwise only enough to engage.
- 5) Slide horizontal bar into slide adaptor block (4), about half the length of the bar.
- 6) Slide pivot head (11) on to horizontal bar (2).
- 7) Insert small locking knob (14) into hole on slide of pivot head (11), turning knob clockwise.
- 8) Install one each small washer (13) over screw threads of swing arm locking handle (10). Temporarily lay this part aside.
- 9) Carefully position one each large washer (12) on each side of the two flat machined surfaces of swing arm (9).
- 10) Carefully holding the two large washer in place, slide swing arm (9) into the slot provided on pivot head (11).
- 11) Insert threads of swing arm locking handle (10) through holes in pivot head (11) and washers (12) and swing arm (9).
- 12) Rotate swing arm locking handle (10) clockwise to engage threads on handle (10) and threads on pivot head (11). Making sure swing arm (9) is in a vertical position, continue turning handle (10) until swing arm (9) is tightly secured.
- 13) Thread counter balance locking knob (6) into threaded hole in counter balance (7).
- 14) Slide counter balance (7) onto end of horizontal bar (2).
- 15) Tighten large knob (6) to secure counter balance (7) to horizontal bar (2).
- 16) Remove bottom plug (8) from swing arm (9).
- 17) Your focusing block (A) will have a knobbed wing nut on rear part of block (A). Loosen wing nut and slide focusing block (A) on to swing arm (9), tightening wing nut to temporarily secure focusing block into place on swing arm.
- 18) Slide support collar (5) on to swing arm (9) and tighten locking screw on support collar to secure it in place on swing arm.
- 19) Replace bottom plug (8) onto swing arm (9).
- 20) Insert microscope head into focusing block (A), following directions in your microscope instruction brochure.
- 21) Exact positioning of microscope can be made by loosening various of the locking knobs and support collars on the stand and sliding the various bars or focusing block to desired position, and then retightening locking knobs and support collars.
- 22) Refer to your microscope instruction brochure for operation of your microscope.

## PARTS DIAGRAM

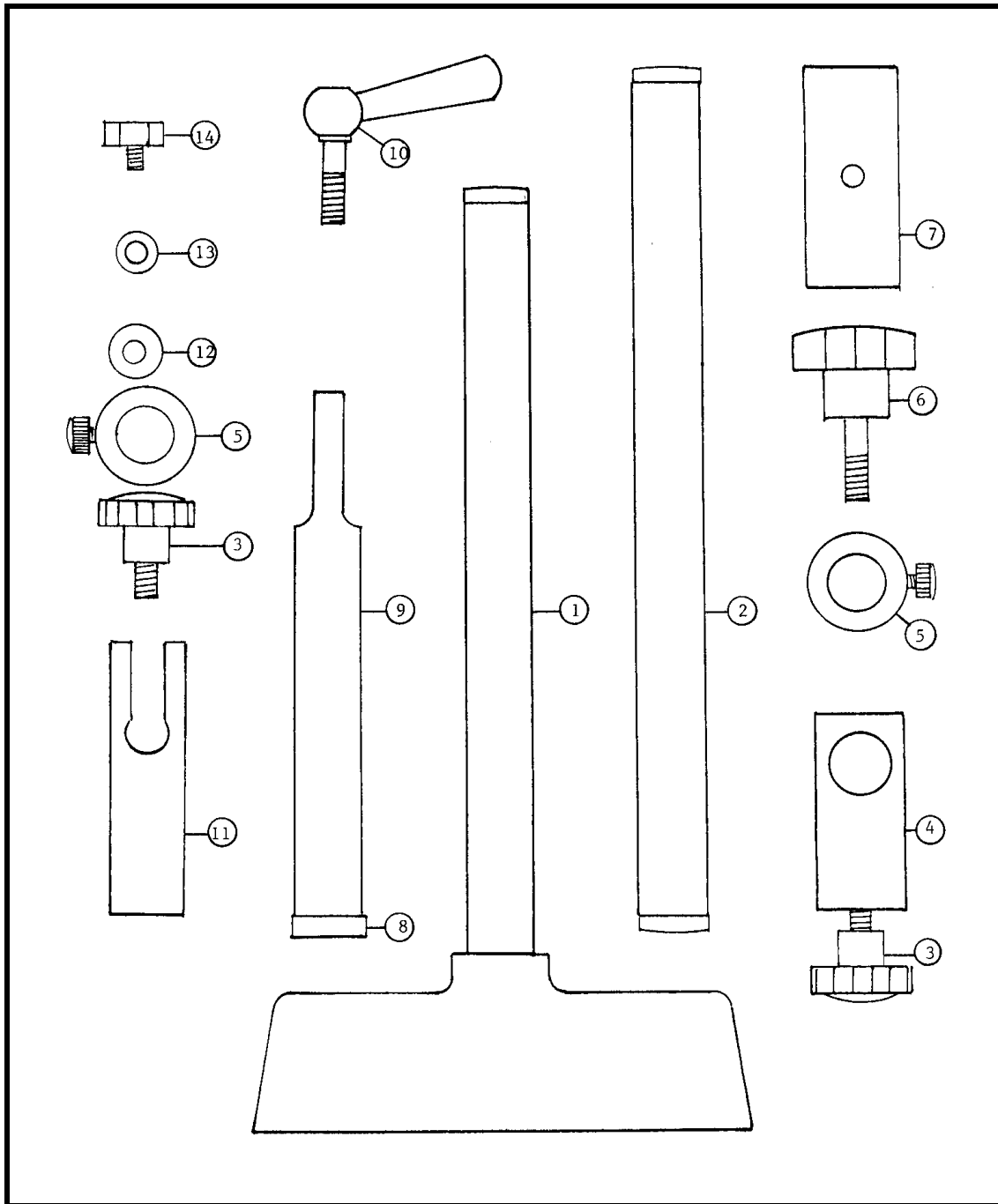

- |   |                                    |
|---|------------------------------------|
| (1) Base with vertical post (O.D. 25mm)           | (8) Bottom plug (1 ea.)            |
| (2) Horizontal bar (O.D. 25mm)                    | (9) Swing arm                      |
| (3) Adaptor block locking knob (38mm) (2 ea.)     | (10) Swing arm locking handle      |
| (4) Adaptor block (horizontal/vertical slide bar) | (11) Pivot head                    |
| (5) Support collar with locking screw (2 ea.)     | (12) Larger washer (2 ea.)         |
| (6) Counter balance locking knob (50mm)           | (13) Small washer (1 ea.)          |
| (7) Counter balance                               | (14) Small locking knob (1 ea.)ivp |